

Tetra® LED Systems

Power Supply

EN Instruction Guide

12
Volt

GEPS12-25U-EU (220-240 VAC input / 12 VDC output / 25W)

Power Supply Features

- Supports all 12 VDC Tetra Products
- SELV Compliant
- 220-240 VAC Input

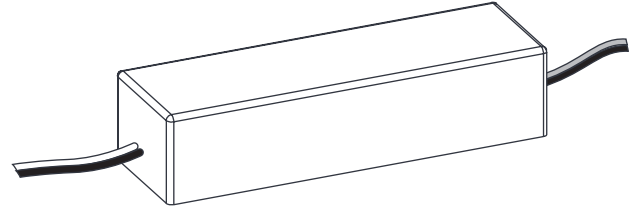

BEFORE YOU BEGIN

Read these instructions completely and carefully.

BG Българската версия на инструкциите за инсталация и информация за безопасност могат да бъдат намерени на следния адрес: https://products.currentbyge.com/eu	FR La version française des instructions d'installations et information de sécurité est disponible à l'adresse suivante: https://products.currentbyge.com/eu	PL Polską wersję instrukcji instalacji oraz informacje dotyczące bezpieczeństwa można znaleźć w następującej lokalizacji: https://products.currentbyge.com/eu
CS Návod k montáži a bezpečnostní informace v češtině najdete zde: https://products.currentbyge.com/eu	HR Hrvatska verzija priručnika za ugradnju i sigurnosnih informacija nalazi se na sljedećoj lokaciji: https://products.currentbyge.com/eu	PT A versão em Português das instruções de instalação e das informações de segurança pode ser encontrada na seguinte localização: https://products.currentbyge.com/eu
DA Den danske version af installationsvejledningen og sikkerhedsoplysninger kan findes på følgende placering: https://products.currentbyge.com/eu	HU A telepítési útmutató és a biztonságos információk magyar nyelvű változata az alábbi címen található: https://products.currentbyge.com/eu	RO Versiunea în limba română a instrucțiunilor de instalare și a informațiilor de siguranță pot fi găsite la: https://products.currentbyge.com/eu
DE Die deutsche Version der Installationsanleitung und Sicherheitsinformationen finden Sie in folgendem Verzeic: https://products.currentbyge.com/eu	IT La versione italiana del manuale di installazione e sicurezza può essere reperita nella seguente sezione: https://products.currentbyge.com/eu	SV Ni hittar den svenska versionen av installationsanvisningarna och säkerhetsinformationen på följande plats: https://products.currentbyge.com/eu
EL Μπορείτε να βρείτε την ελληνική εκδοχή των οδηγιών εγκατάστασης και των πληροφοριών ασφάλειας στην εξής τοποθεσία: https://products.currentbyge.com/eu	LT Lietuvišką diegimo instrukcijos ir saugos informacijos versiją galima rasti šioje vietoje: https://products.currentbyge.com/eu	SL Previdnostna opozorila in varnostne informacije so na zadnji strani vodnika za namestitev. Pred začetkom namestitve izdelka jih skrbno preberite: https://products.currentbyge.com/eu
ES La versión española de las instrucciones de instalación y la información sobre seguridad puede encontrarse en la siguiente ubicación: https://products.currentbyge.com/eu	LV Uzstādīšanas instrukciju un drošības informāciju latviešu valodā var atrast šeit: https://products.currentbyge.com/eu	SK Slovenskú verziu montážnej príručky a bezpečnostných instrukcií nájdete na nasledujúcej lokalite: https://products.currentbyge.com/eu
ET Eestikeelse paigaldusjuhendi ja ohutusnõuded leiate aadressilt: https://products.currentbyge.com/eu	NL De Nederlandse versie van de installatie-instructies en veiligheidsinformatie kan op de volgende locatie worden gevonden: https://products.currentbyge.com/eu	
FI Asennusohjeiden ja turvallisuuatietojen suomenkielinen versio löytyy seuraavasta paikasta: https://products.currentbyge.com/eu		

For the latest North American install guides for your product go to: <https://products.currentbyge.com/led-signage-lighting>

For the latest European install guides for your product go to: <https://products.currentbyge.com/eu>

Save These Instructions

Use only in the manner intended by the manufacturer.
If you have any questions, contact the manufacturer.

⚠ WARNING/AVERTISSEMENT

RISK OF ELECTRIC SHOCK

- Disconnect power at fuse box or circuit breaker before servicing or installing product.
- Properly ground Tetra® power supply.

RISK OF FIRE

- Use only approved wire for input/output connection. Minimum size 18 AWG (0.82 mm²).
- Follow all local codes.
- Application considerations potentially requiring additional spacing include high ambient temperature seen by the power supply, poor contact with a heat dissipating material, inadequate ventilation, or direct exposure to sun.

RISQUES DE DÉCHARGES ÉLECTRIQUES

- Coupez l'alimentation électrique à la boîte de fusibles ou au disjoncteur avant l'entretien ou l'installation du produit.
- Assurez-vous de correctement mettre à terre le bloc d'alimentation Tetra®.

RISQUES D'INCENDIE

- N'utilisez que des fils approuvés pour les entrées/sorties de connexion. Taille minimum 18 AWG (0.82 mm²).
- Respectez tous les codes locaux.
- Certaines applications pourraient requérir un espacement additionnel, p. ex. une température ambiante élevée autour du bloc d'alimentation, un mauvais contact avec une matière dissipatrice de chaleur, une ventilation inadéquate ou une exposition directe au soleil.

⚠ CAUTION/ATTENTION

RISK OF INJURY

- While performing installations described, gloves, safety glasses or goggles should be worn.

RISQUES DE BLESSURE

- Lors de l'exécution des installations décrites, des gants, des lunettes de sécurité ou des lunettes de protection doivent être portées.

Power Supply Installation

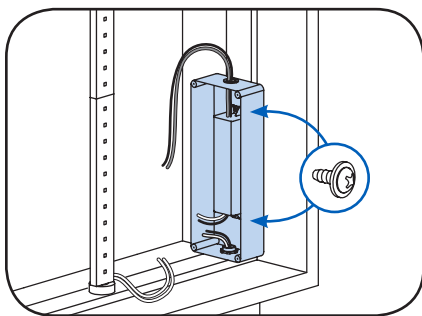

- 1** Mount the power supply. Mounting the power supply base directly to a thermally conductive installation surface can improve thermal performance.

NOTE: All electrical connections should be suitably protected from mechanical damage and the environment. Seal all connections exposed to water with electrical grade self-hardening silicone.

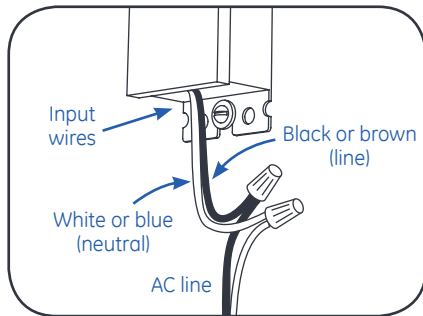

- 2** Connect the AC line to the black or brown (line) and white or blue (neutral) input wires of the power supply using suitable wire connectors.

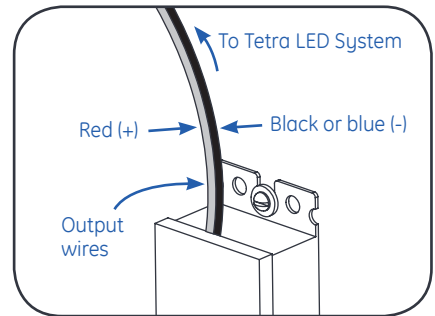

- 3** Connect the supply wire that is attached to the Tetra LED System to the red (+) and black or blue (-) output wires of the power supply as outlined in the **"Electrical Connections"** section of your LED system's Installation Instructions.

NOTE: To avoid overloading this power supply with LED modules, please refer to the specific module loading guides.

⚠ WARNING

RISK OF ELECTRIC SHOCK
AC input connections shall be suitably enclosed.

OPTIONAL

A Weather Box (GEXNWB2) may be used to house and seal Class 2 connections.

A) Insert wire connectors into weather box. Fill with electrical grade silicone and close box.

B) Secure the weather box using a #6 or #8 (M2 or M3) screw.

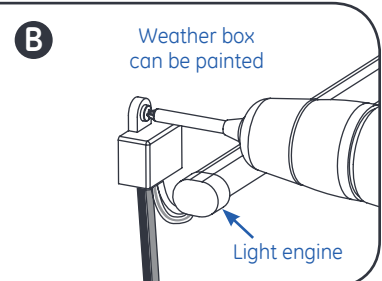
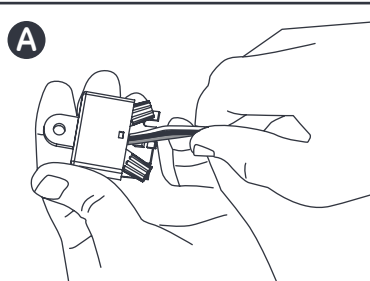

Power Supply Specifications

Performance Data	Min	Typical	Max
Input Voltage (VAC)	194	220-240	264
Input Frequency (Hz)	-	50/60	-
Input Current (A)	0.15 (240VAC)	-	0.2 (194VAC)
THD	-	-	20
PF	0.9	-	-
Output Voltage (VDC)	11.0	12.0	13.0
Output Current (ADC)	-	-	2.0
Output Power (W)	-	-	25
Environmental Operating Temperature Range	-25°C	+25°C	+50°C*
Environmental Humidity (non-condensing)	-	-	95%
Environmental Storage Temperature Range	-10°C	-	+70°C
Environmental Rating	IP66 rated: must be protected from direct exposure to the weather		
Dimensions	5.2 in. x 1.6 in. x 1.2 in. (133 mm x 30.5 mm x 40 mm)		

*Maximum case temperature is 75°C

Troubleshooting

Symptom	Solution
All letters are OFF	<ul style="list-style-type: none"> Recycle AC power, turn it off, then turn on again. If still off, check the power supply DC output voltage using a voltmeter. It should be nominally 12V. <ul style="list-style-type: none"> » If there is DC output, inspect and correct all DC wire damage/polarity issues; If no issue is found, replace the OFF-module string. » If there is no DC output, have a licensed electrician check the input AC voltage and if there is correct AC voltage, replace the power supply. » If there is no AC voltage, correct the upstream AC issue.
Some LEDs appear dim	<ul style="list-style-type: none"> Ensure the overall length of the Tetra® LED System does not exceed the maximum load. Ensure the length of supply wire is equal to or below the recommended remote mounting distance.
Some of the letters are not illuminated	<ul style="list-style-type: none"> Inspect and correct the wires of the non-illuminated letters for damage/polarity issues; If no issues are found, see the troubleshooting solution for "All letters are OFF."
Shadows	<ul style="list-style-type: none"> Re-route supply wire and secure to the back of the can with electrical grade RTV silicone. Adjust wire connector orientation so that it does not cover any LEDs. Adjust LED layout to ensure uniformity of illumination of the face of the letter.

This product is intended to be used as a lamp control gear that is installed after the mains control switch.

Conforms to the following standards:

